

SAMSUNG

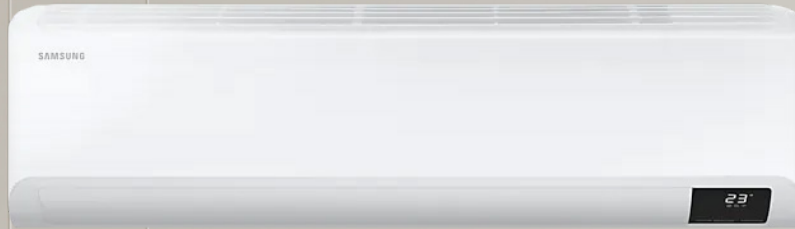

INVERTER MIDWALL SPLIT

AIRCONDITIONER USER MANUAL

SAMSUNG WINDFREE™ AR 8500



Detailed User Manual

Checking on the website

- STEP1** Check the model name.
- STEP2** Go to the Samsung website (<http://www.samsung.com>) or Read the QR code.



- STEP3** Search and check User manual. SUPPORT
> Manuals & Downloads > Search model

Checking in Service Centre

- STEP1** Check the model name.
- STEP2** Contact Service Centre.
- STEP3** Ask for the user manual of your product model.

SmartThings app

Use the SmartThings app on your smartphone to control the air conditioner via the wireless Internet. To remotely control the air conditioner, you need to connect your smartphone to the air conditioner.

Step 1. Checking the requirements for connection

Step 2. Connecting your smartphone to the Wi-Fi network

Step 3. Installing the SmartThings app

Step 4. Configuring the SmartThings app

Step 5. Connecting your smartphone to the air conditioner

Step 6. Controlling the air conditioner with your smartphone

NOTE

- For more information about how to install the SmartThings app, connect it to the product, and control the product with it, read the QR code above and refer to detailed instructions in the user manual.
- You can easily install the SmartThings app or use the product with your smartphone by scanning the QR code on the attached label.

Indoor Unit Overview

The appearance of the actual product may differ slightly from the image below.

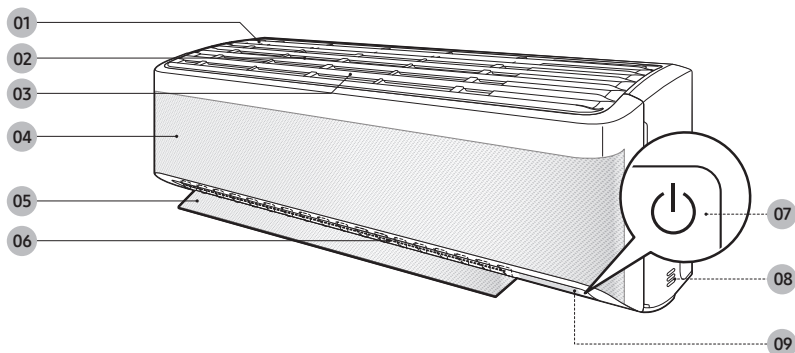

- 01 Air intake
- 02 Air filter
- 03 Tri-care filter
- 04 WindFree panel
- 05 Airflow blade (up and down)

- 06 Airflow blade (left and right)
- 07 Power button/Remote control receiver
- 08 Room temperature sensor
- 09 Display

NOTE

- The product ships with two Tri-care filters and the manual included.

Display

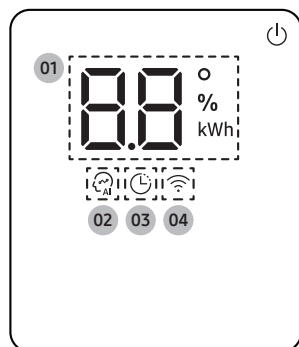

- 01 Temperature indicator (numeric)
Filter reset indicator (C F)
Auto clean indicator (C i)
Defrost indicator (dF)
- 02 AI Auto indicator
- 03 Timer indicator
good'sleep indicator
- 04 Wi-Fi indicator

NOTE

- When the Wi-Fi is turned on, the indicator blinks three times and then turns on.

Operating the Air Conditioner

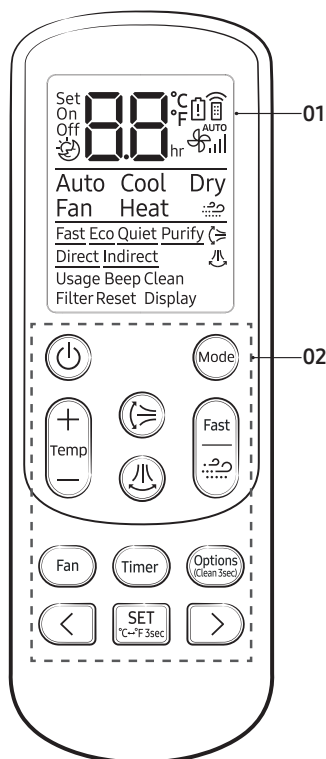

01 Display

02 Button

NOTE

- Although Purify, Direct, Indirect and Usage is displayed on the remote control display, it is not available on this model.
- Features may differ depending on models.

Functions and Buttons

Function	Button and Selection	Display
Power On/Off		
WindFree Cooling	In Cool/Dry/Fan mode ►	
AI Auto	► ► Select Auto.	
Auto	► ► Select Auto.	Auto
Cool	► ► Select Cool.	Cool
Dry	► ► Select Dry.	Dry
Fan	► ► Select Fan.	Fan
Heat	► ► Select Heat.	Heat
Fast	In Cool or Heat mode ►	Fast
Eco	In Cool or Heat mode ► ► ► Select Eco. ►	Eco
Quiet	In Cool or Heat mode ► ► ► Select Quiet. ►	Quiet
Beep	► ► Select Beep. ►	Beep
Display lighting	► ► Select Display. ►	Display

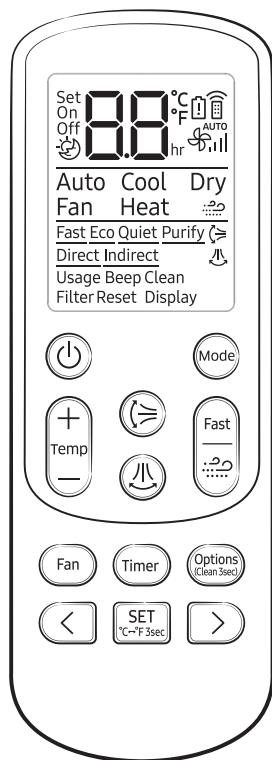

Function	Button and Selection	Display
Wi-Fi (SmartThings)	► Press and hold for 5 or more seconds.	AP
Wi-Fi (On/Off)	and ► Press and hold for 5 or more seconds.	
Timed on/off	► Select On or Off ► (Set the duration.) ► 	On Off 00 hr
good'sleep	In Cool or Heat mode ► (Select) ► (Set the duration.) ► 	80 hr

Cleaning

Auto clean function

Use the Auto clean function if the indoor unit produces odors.

Activating Auto clean

To activate Auto clean, press the  (Options) button for at least 3 seconds.

The indoor unit display shows:

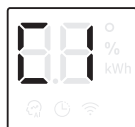

Canceling Auto clean

To cancel Auto clean while it is running, follow the procedure below:



► Press and hold for 3 or more seconds.

Deactivating Auto clean

To deactivate Auto clean, follow the procedure below while the air conditioner is in operation or turned off:



► Select Clean. ►



Cleaning the filter

Clean the air filter every two weeks or when the  F (filter-cleaning reminder) appears on the indoor unit display. The time between cleanings may vary, depending on the usage and environmental conditions.

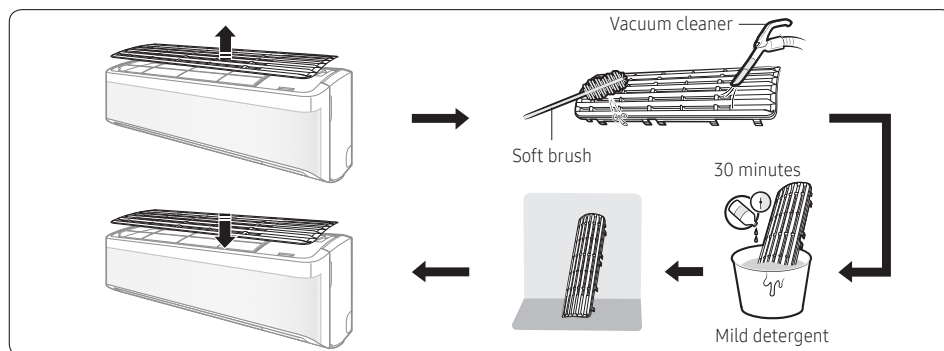

- 1 Slide the filter off of the unit.
- 2 Use a soft brush or vacuum cleaner to remove any dust or debris on the filter.
- 3 Soak the filter in a solution of water and mild detergent for 30 minutes.
- 4 Rinse the filter and let it air dry in a well-ventilated area that is out of direct sunlight.
- 5 Reinstall the filter.
- 6 Reset the filter-cleaning reminder:

In operation ►  ►   ► Select Filter Reset. ► 

Replacing the Tri-care filter

Slide a new Tri-care filter in the direction of arrow 2.

Replace Tri-care filters once every three years. Replacement cycle may differ depending on the environment and usage time.

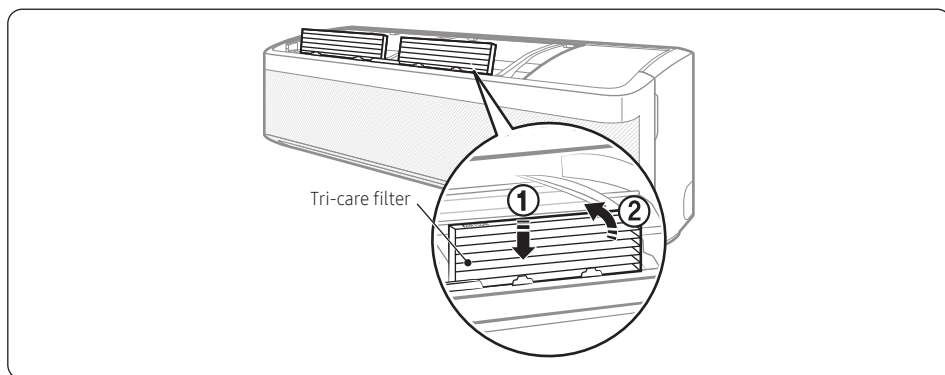

CAUTION

- Do not clean the Tri-care filter with water. Failing to do so may result in damage to the filter.

NOTE

- To replace a Tri-care filter, purchase a new one at a service centre.
- To use the Tri-care filter for a long time in an environment where fish cooking and smoking cause odour, ventilate the place by opening a window.

SAMSUNG

QUESTIONS OR COMMENTS?

COUNTRY	CALL	OR VISIT US ONLINE AT
SOUTH AFRICA	0860 SAMSUNG (726 7864)	www.samsung.com/za/support
NAMIBIA	08 197 267 864	www.samsung.com/africa_en/support
ZAMBIA	0211 350 370	www.samsung.com/africa_en/support
MAURITIUS	800 5050	www.samsung.com/africa_en/support
REUNION	0262 50 88 80	www.samsung.com/africa_fr/support
MOZAMBIQUE	84 726 7864	www.samsung.com/africa_pt/support
NIGERIA	0800 726 7864	www.samsung.com/africa_en/support
Ghana	0800 100 077	www.samsung.com/africa_en/support
Cote D'Ivoire	8000 0077	www.samsung.com/africa_fr/support
SENEGAL	800 00 0077	www.samsung.com/africa_fr/support
CAMEROON	67095 0077	www.samsung.com/africa_fr/support
KENYA	0800 545 545	www.samsung.com/africa_en/support
UGANDA	0800 300 300	www.samsung.com/africa_en/support
TANZANIA	0800 780 089	www.samsung.com/africa_en/support
SUDAN	1969	www.samsung.com/eg/support

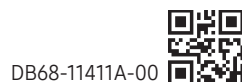

DB68-11411A-00